

WARNING HYDRAULIC POST DRIVER SAFETY

Any piece of equipment can be dangerous if not operated properly. **YOU** are responsible for the safe operation of this equipment. The operator must carefully read and follow any warnings, safety signs and instructions provided with or located on the equipment. Do not remove, defeat, deface or render inoperable any of the safety devices or warnings on this equipment. **IF** any safety devices or warnings have been removed, defeated, defaced, or rendered inoperable, **DO NOT USE THIS EQUIPMENT!!!**

⚠ WARNING: This product can expose you to chemicals including naphthalene from petroleum products which are known to the State of California to cause cancer and birth defects or other reproductive harm. For more information go to www.P65warnings.ca.gov

<<<WARNING >>>

THE EQUIPMENT PROTECTION PLAN DOES NOT COVER DAMAGE TO HOSES AND FITTINGS. CUSTOMER IS RESPONSIBLE FOR ALL HOSE AND FITTING DAMAGE!

DANGER: Exercise special care whenever entering or exiting a skid steer loader with an auxiliary attachment installed. Hoses, mounting brackets, and even the attachment itself can be a trip hazard and could cause you to fall.

Danger: This tool has and creates multiple pinch points. Keep hands, feet, and other body parts clear at all times.

NEVER TOUCH A LEAKING HYDRAULIC HOSE IT CAN PIERCE YOUR SKIN! Escaping hydraulic oil under pressure can have sufficient force to penetrate your skin, causing serious personal injury. If injured by escaping fluid, obtain medical treatment immediately!

KEEP BYSTANDERS AWAY. To avoid injury from flying objects, be sure others stay well away from the driver when it is operating.

ALWAYS wear eye and hearing protection. We recommend wearing a face shield as additional face and eye protection.

IMPORTANT SAFETY RULES TO FOLLOW

BOOM DOWN PRESSURE: Proper boom down pressure must be applied to achieve maximum driving ability. If the down pressure is not sufficient, the energy created will be transferred to the carrier, not the post or pole being driven. This could lead to stress on the attachment and the carrier, which could result in damage.

THRUST DIRECTION: Always position the driver perpendicular to the work surface. As the driver travels downward, it will follow a curved path. Always reposition the carrier to keep perpendicular to the work. If driving is done at an angle other than perpendicular, the tool may slip off the post or pole.

DRY FIRING THE DRIVER: As soon as the post or pole has been driven to the desired depth, discontinue hammering immediately. The driver and carrier may be adversely affected by idle strokes. **AVOID MOVING OBJECTS WITH DRIVER** Do Not use the driver or working steel to roll, push material or reposition the carrier. This may cause damage to the mounting bolts, side plates, working steel or the carrier itself.

PRYING: Do not pry with the working steel, under any circumstances. This may cause damage to the bolts or failure of the working steel.

LIFTING: Never use the working steel or driver to lift with. This is dangerous and could damage the driver or working steel.

POSITIONING THE DRIVER: Always maintain control of the driver when positioning the working steel. Do not let the driver drop on the material being driven. This could damage the driver & base machine.

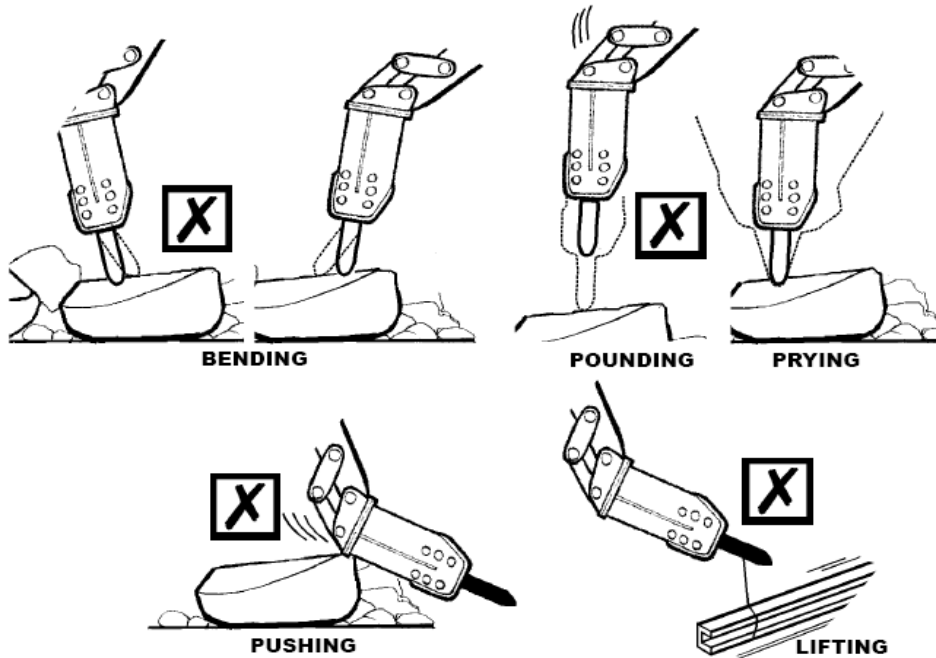

Warning metal conducts electricity. Do Not use this Breaker where it may come into contact with power lines or other electric circuits. Failure to comply to this warning will result in serious personal injury or death. Keep appropriate distances from High Voltage lines.

Smart digging means calling 811 before each job. Whether you are a homeowner or a professional excavator, one call to 811 gets your underground utility lines marked for FREE!

If the person receiving this handout will not be the user of the equipment, forward these instructions to the operator. **IF** there is any doubt as to the operation or safety of the equipment, **DO NOT USE!!! CALL A TOOL SHED IMMEDIATELY!!! FAILURE TO FOLLOW THESE INSTRUCTIONS COULD RESULT IN INJURY OR DEATH**